

# Wendeschneidplatten

Replaceable inserts  
Plaquettes de coupe

Form 111  
SCGT0703..

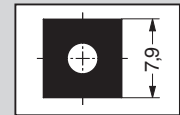

Geometrie		Bestell-Nr. Schneidstoff		Radius Radius Rayon	Toleranzklasse Tolerance group Groupe de tolérances	ISO-Bezeichnung ISO Code Désignation ISO		P	M	K	N
Geometry	Order No. Carbide grades	No de cde. Matériaux de coupe									
Géométrie											
180		F111 04 GN 180	WHW01	0,4	G	SCGT070304	1			⊙ ⊙ ▽▽▽	⊙ ⊙ ▽▽▽
		F111 04 GN 180	WHC05	0,4	G	SCGT070304	1	⊙ ⊙ ▽▽▽	⊙ ⊙ ▽▽▽	⊙ ⊙ ▽▽▽	



Zubehör/Ersatzteile	Schlüsselweite	Anziehdrehmoment	Bestell-Nr.	
Accessories/Spare parts	Key size	Torque	Order No.	
Accessoires/Pièces de rechange	Dim. de la clé	Couple de serrage	No de cde.	
<b>Senkschraube</b>				
Countersunk screw M3x7,5	T8	1,2 Nm	115 531	
Vis à tête conique				
<b>Bedienungsschlüssel, Torx</b>				
Service key, Torx	T8		115 590	
Clé de service, Torx				
<b>Drehmoment-Schraubendreher, Torx</b>				
Torque screwdriver, Torx	T8	1,2 Nm	415 514	
Clé dynamométrique, Torx				

Bestell-Beispiel / Ordering example / Exemple de commande :  
F111 04 GN 180 WHW01

# Wendeschneidplatten

Replaceable inserts

Plaquettes de coupe

Form 112

SC..09T3..

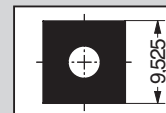

Geometrie <i>Geometry</i> Géométrie		Bestell-Nr. Schneidstoff <i>Order No.</i> <i>Carbide grades</i>		Radius <i>Radius</i> Rayon	Toleranzklasse <i>Tolerance group</i> Groupe de tolérances	ISO-Bezeichnung <i>ISO Code</i> Désignation ISO		P	M	K	N
108		F112 04 MN 108	WHC98					0,4	M	SCMT09T304	1
127		F112 04 GN 127 (097 539)	WHW01	0,4	G	SCGT09T304	1				
140		F112 04 MN 140 (097 673)	WHC61	0,4	M	SCMT09T304	1				
		F112 08 MN 140 (297 371)	WHC61	0,8	M	SCMT09T308	1				
		F112 04 MN 140 (097 673)	WHC73	0,4	M	SCMT09T304	2				
		F112 08 MN 140 (297 371)	WHC73	0,8	M	SCMT09T308	2				
145		F112 08 GN 145	WHC111	0,8	G	SCGT09T308	1				
160		F112 04 MN 160 (097 250)	WHC30	0,4	M	SCMT09T304	1				
176		F112 04 MN 176 (297 498)	WHC79	0,4	M	SCMT09T304	1				



S

Zubehör/Ersatzteile <i>Accessories/Spare parts</i> Accessoires/Pièces de rechange	Schlüsselweite <i>Key size</i> Dim. de la clé	Anziehdrehmoment <i>Torque</i> Couple de serrage	Bestell-Nr. <i>Order No.</i> No de cde.	
<b>Senkschraube</b> <i>Countersunk screw</i> Vis à tête conique	M 3,5 x 7,5 T15	3,0 Nm	115 672 (< Ø 37 mm) 115 673 (> Ø 37 mm)	
<b>Bedienungsschlüssel, Torx</b> <i>Service key, Torx</i> Clé de service, Torx	T15		115 664	
<b>Drehmoment-Schraubendreher, Torx</b> <i>Torque screwdriver, Torx</i> Clé dynamométrique, Torx	T15	3,0 Nm	415 510	

Bestell-Beispiel / Ordering example / Exemple de commande :  
F112 04 GN 127 WHW01 (097 539 WHW01)

# Wendeschneidplatten

Replaceable inserts  
Plaquettes de coupe

Form 113

SC..1204..

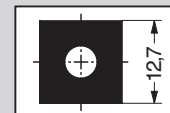

Geometrie <i>Geometry</i> Géométrie	Bestell-Nr. Schneidstoff <i>Order No.</i> <i>Carbide grades</i> No de cde. Matériaux de coupe	Radius <i>Radius</i> Rayon	Toleranzklasse <i>Tolerance group</i> Groupe de tolérances	ISO-Bezeichnung <i>ISO Code</i> Désignation ISO	P	M	K	N
108	F113 04 MN 108 WHC98	0,4	M	SCMT120404				
	F113 08 MN 108 WHC98	0,8	M	SCMT120808				
127	F113 08 GN 127 (097 566)	0,8	G	SCGT120408				
140	F113 04 MN 140 (097 674)	0,4	M	SCMT120404				
	F113 08 MN 140 (297 372)	0,8	M	SCMT120408				
	F113 04 MN 140 (097 674)	0,4	M	SCMT120404				
	F113 08 MN 140 (297 372)	0,8	M	SCMT120408				
145	F113 08 GN 145 WHC111	0,8	G	SCGT120408				
158	F113 08 MN 158 (297 497)	0,8	M	SCMT120408				
160	F113 08 MN 160 (097 251)	0,8	M	SCMT120408				

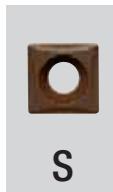

Zubehör/Ersatzteile <i>Accessories/Spare parts</i> Accessoires/Pièces de rechange	Schlüsselweite <i>Key size</i> Dim. de la clé	Anziehdrehmoment <i>Torque</i> Couple de serrage	Bestell-Nr. <i>Order No.</i> No de cde.	
<b>Senkschraube</b> <i>Countersunk screw</i> Vis à tête conique	M4,5x11,5	T20	5,0 Nm	215 149
<b>Bedienungsschlüssel, Torx</b> <i>Service key, Torx</i> Clé de service, Torx	T20		215 150	
<b>Drehmoment-Schraubendreher, Torx</b> <i>Torque screwdriver, Torx</i> Clé dynamométrique, Torx	T20	5,0 Nm	415 543	

Bestell-Beispiel / Ordering example / Exemple de commande :  
F113 08 GN 127 WHW01 (097 566 WHW01)

# Wendeschnidplatten



Replaceable inserts

Plaquettes de coupe

Form 114

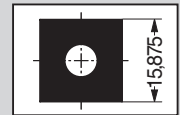
SCMM1505..



Geometrie Geometry Géométrie	Bestell-Nr. Schneidstoff Order No. Carbide grades No de cde. Matériaux de coupe	Radius Radius Rayon	Toleranzklasse Tolerance group Groupe de tolérances	ISO-Bezeichnung ISO Code Designation ISO	P	M	K	N
<b>170</b> 	<b>F114 12 MN 170</b> (097 252) <b>WHC30</b>	1,2	M	SCMM150512 <span style="border: 1px solid black; padding: 0 2px;">1</span>				

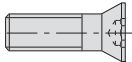
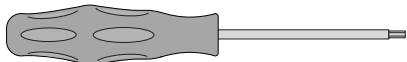
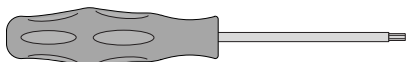

S

Zubehör/Ersatzteile Accessories/Spare parts Accessoires/Pièces de rechange	Schlüsselweite Key size Dim. de la clé	Anziehdrehmoment Torque Couple de serrage	Bestell-Nr. Order No. No de cde.	
<b>Senkschraube</b> Countersunk screw Vis à tête conique	M 4,5 x 11,5	T20	5,0 Nm	<b>215 149</b> 
<b>Bedienungsschlüssel, Torx</b> Service key, Torx Clé de service, Torx	T20			<b>215 150</b> 
<b>Drehmoment-Schraubendreher, Torx</b> Torque screwdriver, Torx Clé dynamométrique, Torx	T20	5,0 Nm		<b>415 543</b> 





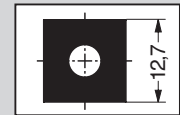

Bestell-Beispiel / Ordering example / Exemple de commande :  
F114 12 MN 170 WHC30 (097 252 WHC30)

# Wendeschneidplatten

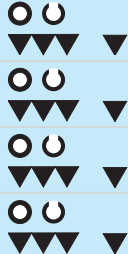
Replaceable inserts  
Plaquettes de coupe

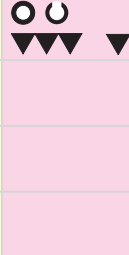
Form 133  
SNMG1204..

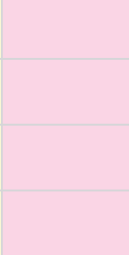

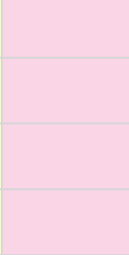



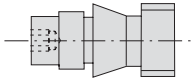
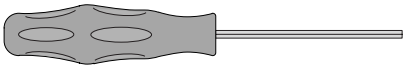



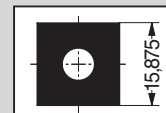









Geometrie		Bestell-Nr.					P	M	K	N
Geometry		Schneidstoff								
Géométrie		Order No.	Radius	Toleranzklasse	ISO-Bezeichnung					
		Carbide grades	Radius	Tolerance group	ISO Code					
		No de cde.	Rayon	Groupe de tolérances	Désignation ISO					
		Matériaux de coupe								
118		F133 04 MN 118 (297 568)	WHC68	0,4	M	SNMG120404				
		F133 08 MN 118 (297 570)	WHC68	0,8	M	SNMG120408				
		F133 04 MN 118 (297 568)	WHC69	0,4	M	SNMG120404				
		F133 08 MN 118 (297 570)	WHC69	0,8	M	SNMG120408				



Zubehör/Ersatzteile	Schlüsselweite	Bestell-Nr.	
Accessories/Spare parts	Key size	Order No.	
Accessoires/Pièces de rechange	Dim. de la clé	No de cde.	
<b>Spannbolzen</b>			
Clamping bolt	s2,5	115 775	
Boulon de serrage			
<b>Bedienungsschlüssel</b>			
Service key	s2,5	115 575	
Clé de service			

Bestell-Beispiel / Ordering example / Exemple de commande :  
F133 04 MN 118 WHC68 (297 568 WHC68)



Geometrie <i>Geometry</i> Géométrie	Bestell-Nr. Schneidstoff <i>Order No.</i> <i>Carbide grades</i>	Radius <i>Radius</i> Rayon	Toleranzklasse <i>Tolerance group</i> Groupe de tolérances	ISO-Bezeichnung <i>ISO Code</i> Désignation ISO	P	M	K	N
119	 F134 16 MN 119 (297 571) WHC68	1,6	M	SNMG150616 [2]				
	 F134 08 MN 119 (297 572) WHC69	0,8	M	SNMG150608 [2]				
	 F134 12 MN 119 (297 573) WHC69	1,2	M	SNMG150612 [2]				
	 F134 16 MN 119 (297 571) WHC69	1,6	M	SNMG150616 [2]				
157	 F134 12 MN 157 (297 640) WHC23	1,2	M	SNMG150612 [1]				
	 F134 12 MN 157 (297 640) WHC33	1,2	M	SNMG150612 [2]				
	 F134 08 MN 157 (097 971) WHC71	0,8	M	SNMG150608 [1]				
	 F134 12 MN 157 (297 640) WHC72	1,2	M	SNMG150612 [2]				

Zubehör/Ersatzteile <i>Accessories/Spare parts</i> Accessoires/Pièces de rechange	Schlüsselweite (SW) <i>Key size</i> Dim. de la clé	Anziehdrehmoment <i>Torque</i> Couple de serrage	Bestell-Nr. <i>Order No.</i> No de cde.
---	--	--	---

③ Spannsatz, kpl.

*Clamping set, compl.*

Jeu de serrage, compl.

315 001

③.1 Spannschraube

*Clamping screw*

Jeu de serrage

s3

215 566

③.2 Auflageplatte

*Seat*

Plaque

215 575

③.3 Spannhebel

*Clamping lever*

Levier

215 573

③.4 Hülse

*Sleeve*

Douille

215 576

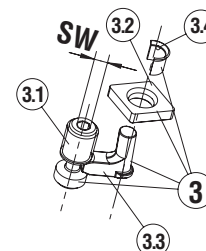

Montagedorn für Hülse

*Mounting arbor for sleeve*

Mandrin de montage pour douille

415 644

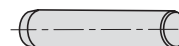

Spannbolzen

*Clamping bolt*

Boulon de serrage

s3

0,6 Nm

115 776

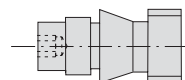

Bedienungsschlüssel

*Service key*

Clé de service

s3

115 630

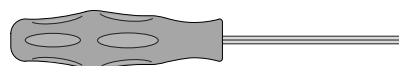

Bestell-Beispiel / Ordering example / Exemple de commande :  
F134 16 MN 119 WHC68 (297 571 WHC68)

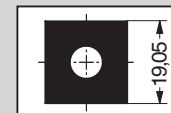

Geometrie <i>Geometry</i> Géométrie	Bestell-Nr. Schneidstoff <i>Order No.</i> <i>Carbide grades</i> No de cde. Matériaux de coupe	Radius <i>Radius</i> Rayon	Toleranzklasse <i>Tolerance group</i> Groupe de tolérances	ISO-Bezeichnung <i>ISO Code</i> Désignation ISO	P	M	K	N
157	F136 12 MN 157 (297 760) WHC23 1,2 M SNMG190612 1				○ ○ ▼		○ ○ ▼	
	F136 12 MN 157 (297 760) WHC33 1,2 M SNMG190612 1				○ ○ ▼			
	F136 12 MN 157 (297 760) WHC71 1,2 M SNMG190612 1					○ ○ ▼		
	F136 12 MN 157 (297 760) WHC72 1,2 M SNMG190612 2						○ ○ ▼	

Zubehör/Ersatzteile <i>Accessories/Spare parts</i> Accessoires/Pièces de rechange	Schlüsselweite (SW) <i>Key size</i> Dim. de la clé	Bestell-Nr. <i>Order No.</i> No de cde.
---	--	---

③ Spannsatz, kpl.

*Clamping set, compl.*  
*Jeu de serrage, compl.*

315 066

③.1 Spannschraube

*Clamping screw*  
*Jeu de serrage*

s4

215 581

③.2 Auflageplatte

*Seat*  
*Plaque*

215 201

③.3 Spannhebel

*Clamping lever*  
*Levier*

215 200

③.4 Hülse

*Sleeve*  
*Douille*

215 212

Montagedorn für Hülse

*Mounting arbor for sleeve*  
*Mandrin de montage pour douille*

415 643

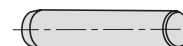

Bedienungsschlüssel

*Service key*  
*Clé de service*

s4

415 164

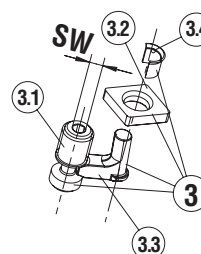
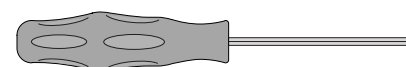

Bestell-Beispiel / Ordering example / Exemple de commande :  
F136 12 MN 157 WHC23 (297 760 WHC23)

# Wendeschnidplatten

Replaceable inserts

Plaquettes de coupe

Form 137  
SNMG2507..

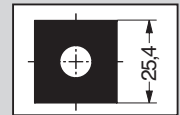

Geometrie		Bestell-Nr.		Radius	Toleranzklasse	ISO-Bezeichnung		P	M	K	N
Geometry	Schneidstoff	Order No.	Schneidstoff								
Géométrie		Carbide grades		Rayon	Tolerance group	Désignation ISO					
		No de cde.	Matériaux de coupe		Gruppe de tolérances						
163		F137 24 MN 163 (297 639)	WHC23	2,4	M	SNMM250724	1				
		F137 24 MN 163 (297 639)	WHC33	2,4	M	SNMM250724	2				



S

Zubehör/Ersatzteile	Schlüsselweite	Bestell-Nr.	
Accessories/Spare parts	Key size	Order No.	
Accessoires/Pièces de rechange	Dim. de la clé	No de cde.	
<b>Spannschraube / Spannbolzen</b>			
Clamping screw / Clamping bolt	s5	315 805	
Vis de serrage / Boulon de serrage			
<b>Bedienungsschlüssel</b>			
Service key	s5	415 165	
Clé de service			

Bestell-Beispiel / Ordering example / Exemple de commande :  
F137 24 MN 163 WHC23 (297 639 WHC23)